

Beadalon®

Flat Memory Wire End Caps

Expert to secure rings, necklaces, and bracelets!



FLAT MEMORY WIRE END CAPS INSTRUCTIONS

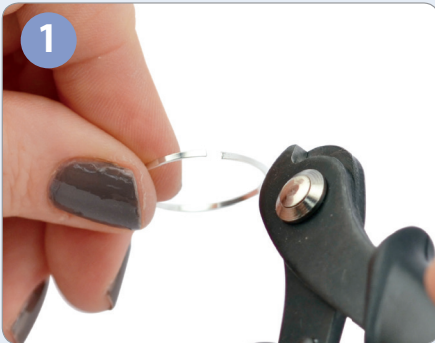

1 Use Memory Wire Shears to cut Memory Wire. In this example, cut single loop off the ring-size coil of Memory Wire so there is a gap of about 1/8" between the ends.



2 For this example, slide the Circle Flat Memory Wire Finding onto the wire then glue (with Beadalon Beadfix Adhesive) the focal component onto the Finding onto the center of the wire.



3 Then glue with Beadalon Beadfix Adhesive a Flat Memory Wire End Cap to each end of the wire.



*Beadalon Beadfix Gel Adhesive
Is The Perfect Product To Adhere
Flat Memory Wire End Caps!*

